



## CCR0AD

**14W or 19W – Continuous duty – ED100%**  
**Robust design with outer metal cage**

### Description & Operation

External plated metal cage and shims to maximize electromagnetic output. Metal parts protected against oxidation according to RoHS directive. Bore size: Ø16.1 mm. Suitable for HEAVY DUTY operations.



### Technical Data

Power	14W or 19W
Various Voltage Options Available	Both AC and DC
Coil Insulation Class	H (180°C)
Wire Insulation Class	H (180°C)
ED	100%
Supply Power Tolerance	±10%DC; +10% -5%AC
Ambient Temperature Range	-40°C. 80°C
IP coil with connector	See page
IP coil	69k
Weight	0.21kg

### Dimensional Drawing

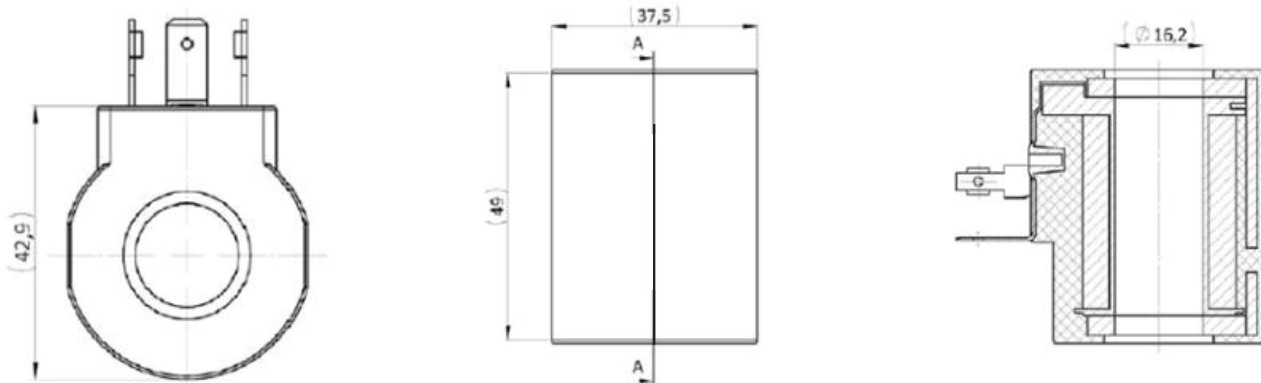

 **Performance Details**

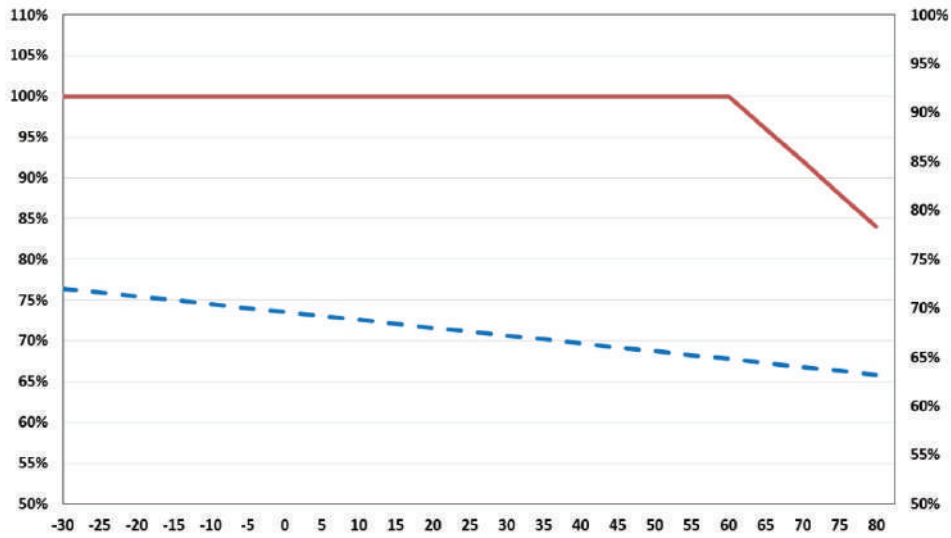

 **Ordering Code**

<b>C</b>	<b>C</b>	<b>R</b>	<b>O</b>	<b>A</b>	<b>D</b>	<b>*</b>	<b>*</b>	<b>*</b>	<b>I</b>	<b>0</b>	<b>*</b>	<b>*</b>
----------	----------	----------	----------	----------	----------	----------	----------	----------	----------	----------	----------	----------

**Coil Basic Code**

**BOOR SIZE**  
A=016.00 mm

**TYPE OF CURRENT**  
C= Direct current

**POWER**  
E=19W  
M=14W

**MAKING**  
0= Standard factory marking  
Customized marking can e doneupon request.

Model Code	Type of Connector
08	DEUTSCH (90°)

**COILS**